

Installation,  
Operation, and  
Maintenance Manual

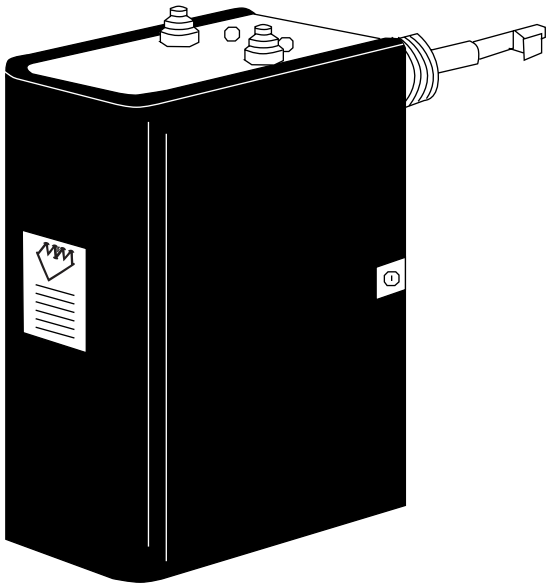

---

# PSE-800-M Low Water Cut-off

---



**McDonnell & Miller**  
a xylem brand



---

# Table of Contents

|  |    |
|--|----|
| <b>Introduction and Safety</b> .....                         | 2  |
| Introduction.....  | 2  |
| Safety.....  | 2  |
| Safety terminology and symbols.....                          | 2  |
| User safety.....   | 3  |
| Product warranty.....  | 4  |
| <b>Product Description</b> .....                             | 5  |
| General description.....                                     | 5  |
| Operational specifications.....                              | 5  |
| Electrical specifications.....                               | 6  |
| <b>Installation</b> .....                                    | 7  |
| Determine location for the probe installation.....           | 7  |
| Install the probe.....                                       | 7  |
| Install the control housing.....                             | 8  |
| Wire the probe to the control housing.....                   | 8  |
| Control to boiler wiring.....                                | 9  |
| Electrical conduit connections.....                          | 9  |
| Wire connections to the terminal block.....                  | 9  |
| Option A wiring.....   | 10 |
| Option B wiring.....   | 10 |
| Option C wiring.....   | 11 |
| <b>Commissioning, Startup, Operation, and Shutdown</b> ..... | 13 |
| Start up the boiler.....                                     | 13 |
| Test the probe.....  | 13 |
| Test the manual reset button.....                            | 13 |
| <b>Maintenance</b> .....                                     | 14 |
| Maintenance schedule.....                                    | 14 |
| <b>Troubleshooting</b> .....                                 | 15 |
| Probe fails to operate.....                                  | 15 |

# Introduction and Safety

## Introduction

### Purpose of this manual

The purpose of this manual is to provide necessary information for:

- Installation
- Operation
- Maintenance



---

**CAUTION:**

Read this manual carefully before installing and using the product. Improper use of the product can cause personal injury and damage to property, and may void the warranty.

---

---

**NOTICE:**

Save this manual for future reference, and keep it readily available at the location of the unit.

---

## Safety



---

**WARNING:**

- The operator must be aware of safety precautions to prevent physical injury.
  - Any pressure-containing device can explode, rupture, or discharge its contents if it is over-pressurized. Take all necessary measures to avoid over-pressurization.
  - Operating, installing, or maintaining the unit in any way that is not covered in this manual could cause death, serious personal injury, or damage to the equipment. This includes any modification to the equipment or use of parts not provided by Xylem. If there is a question regarding the intended use of the equipment, please contact a Xylem representative before proceeding.
  - This manual clearly identifies accepted methods for disassembling units. These methods must be adhered to. Trapped liquid can rapidly expand and result in a violent explosion and injury. Never apply heat to impellers, propellers, or their retaining devices to aid in their removal.
  - Do not change the service application without the approval of an authorized Xylem representative.
- 



---

**CAUTION:**

You must observe the instructions contained in this manual. Failure to do so could result in physical injury, damage, or delays.

---



## Safety terminology and symbols

### About safety messages

It is extremely important that you read, understand, and follow the safety messages and regulations carefully before handling the product. They are published to help prevent these hazards:

- Personal accidents and health problems
- Damage to the product
- Product malfunction

## Hazard levels

| Hazard level   | Indication   |
|--|--|
|  <p><b>DANGER:</b></p>  | A hazardous situation which, if not avoided, will result in death or serious injury  |
|  <p><b>WARNING:</b></p> | A hazardous situation which, if not avoided, could result in death or serious injury   |
|  <p><b>CAUTION:</b></p> | A hazardous situation which, if not avoided, could result in minor or moderate injury  |
| <p><b>NOTICE:</b></p>  | <ul style="list-style-type: none"> <li>• A potential situation which, if not avoided, could result in undesirable conditions</li> <li>• A practice not related to personal injury</li> </ul> |

## Hazard categories

Hazard categories can either fall under hazard levels or let specific symbols replace the ordinary hazard level symbols.

Electrical hazards are indicated by the following specific symbol:



**Electrical Hazard:**

These are examples of other categories that can occur. They fall under the ordinary hazard levels and may use complementing symbols:

- Crush hazard
- Cutting hazard
- Arc flash hazard

## User safety

## General safety rules

These safety rules apply:

- Always keep the work area clean.
- Pay attention to the risks presented by gas and vapors in the work area.
- Avoid all electrical dangers. Pay attention to the risks of electric shock or arc flash hazards.
- Always bear in mind the risk of drowning, electrical accidents, and burn injuries.

## Safety equipment

Use safety equipment according to the company regulations. Use this safety equipment within the work area:

- Hard hat
- Safety goggles, preferably with side shields

- Protective shoes
- Protective gloves
- Gas mask
- Hearing protection
- First-aid kit
- Safety devices

---

**NOTICE:**

Never operate a unit unless safety devices are installed. Also see specific information about safety devices in other chapters of this manual.

---

### Electrical connections

Electrical connections must be made by certified electricians in compliance with all international, national, state, and local regulations. For more information about requirements, see sections dealing specifically with electrical connections.

## Product warranty

### Coverage

Xylem undertakes to remedy defects in products from Xylem under these conditions:

- The faults are due to defects in design, materials, or workmanship.
- The faults are reported to an local sales and service representative within the warranty period.
- The product is used only under the conditions described in this manual.
- The monitoring equipment incorporated in the product is correctly connected and in use.
- All service and repair work is done by Xylem authorized personnel.
- Genuine Xylem parts are used.
- Only Ex-approved spare parts and accessories authorized by an EX-approved Xylem representative are used in Ex-approved products.

### Limitations

The warranty does not cover defects caused by these situations:

- Deficient maintenance
- Improper installation
- Modifications or changes to the product and installation made without consulting an Xylem authorized representative
- Incorrectly executed repair work
- Normal wear and tear

Xylem assumes no liability for these situations:

- Bodily injuries
- Material damages
- Economic losses

### Warranty claim

Xylem products are high-quality products with expected reliable operation and long life. However, should the need arise for a warranty claim, then contact your local sales and service representative.

# Product Description

## General description

### Description

The probe is a manual reset low water cut-off control. The control unit has a red LED light to alert personnel to a low water condition and a green LED to indicate normal operation.

### Lockout delay

When a low water condition occurs, the burner turns off and the red LED begins to blink. When the water level is not restored to a level above the probe within 60 seconds, the control locks out. Press the reset button when the water level is restored to a level above the probe.

### Power interruption

The control will automatically reset after a loss of power as long as there is water on the probe before and after the power loss occurred.

### CSD-1 code compliance

For manual reset units, when the control is in a low water condition and there is an interruption of power the control remains in that condition when power is restored. Press the reset button when the water level is restored to a level above the probe.

---

#### NOTICE:

Flood hazard. Do not use manual reset models with automatic water feeders.

---

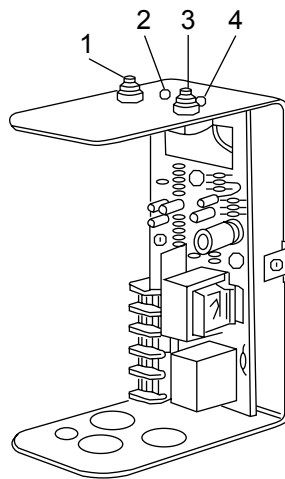

1. Test button
2. Power on LED, green
3. Reset button
4. Low water LED, red

Figure 1: Control unit

## Operational specifications

### Control unit ratings

|                     |                                |
|---------------------|--------------------------------|
| Storage temperature | -40°F to 135°F (-40°C to 57°C) |
| Ambient temperature | 32°F to 120°F (0°C to 49°C)    |

|          |                    |
|----------|--------------------|
| Humidity | 85% non-condensing |
|----------|--------------------|

Probe specifications

Maximum steam pressure: 15 psi (1.0 kg/cm<sup>2</sup>)

Probe dimensions in inches (mm)

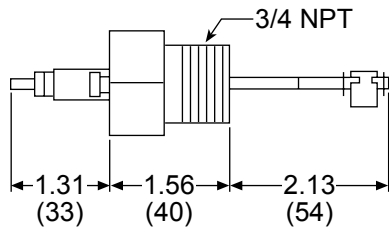

Figure 2: Standard probe

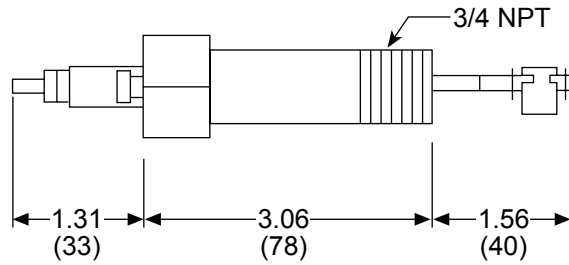

Figure 3: "U" probe

## Electrical specifications

Ratings

| Model           | Control Voltage | Motor Switch rating |          | Pilot rating |
|-----------------|-----------------|---------------------|----------|--------------|
| PSE-802-M-24    | 24 VAC          | N/A                 |          | 50 VA        |
| PSE-802-M-U-24  |                 |                     |          |              |
| PSE-801-M-120   | 120 VAC         | 7.5 FLA             | 43.2 LRA | 125 VA       |
| PSE-801-M-U-120 |                 |                     |          |              |

Hertz

50/60

Control power consumption

- 1.7 VA at 24 VAC
- 3.6 VA at 120 VAC

Electrical enclosure rating

- NEMA 1 general purpose

Agency listings





# Installation

## Determine location for the probe installation



---

### DANGER:

Electrical hazard sufficient to kill. Always disconnect and lock out the power before you service the unit.

---



---

### NOTICE:

- Low water cut-off must be installed in series with all other limit and operating controls on the boiler. Check for proper operation of all of the limit and operating controls before leaving the site.
  - All work must be performed by qualified personnel trained in the proper application, installation, and maintenance of plumbing, steam and electrical equipment or systems in accordance with all applicable codes and regulations.
- 

Use the following criteria to locate a suitable position to install the probe .

- Install probe in a tapping on the boiler that is designated by the boiler manufacturer. Review boiler IOMs or contact manufacturer for location of tapping.
- Probe must be installed below the location or level of the existing automatic reset low water cut-off (LWCO). Installing the probe above this location could result in nuisance shutdowns or lockouts.
- Install probe in a location above the minimum safe water level as designated by the boiler manufacturer.
- Installing the probe in a location other than a tapping designated by the boiler manufacturer could result in nuisance shutdowns of the burner.
- There must be at least 1/4 in of clearance between the end of the probe and the wall of any piping or fitting.
- Do not install the probe in any pipe extension that covers all or part of the probe rod. Water that is retained in a pipe extension and touches the probe prevents the probe from recognizing a low water condition. The burner will not shut off.

## Install the probe

1. Apply a small amount of pipe sealant to the external threads (2) of the probe (1).

**IMPORTANT:** Do not use PTFE tape. Only use a pipe sealant.

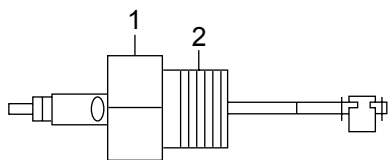

2. Tighten the probe (1) into the tapped connection (3) to 47 ft·lb (64 N·m). Be sure to align the probe so that the mounting screws (4) are in a horizontal position.

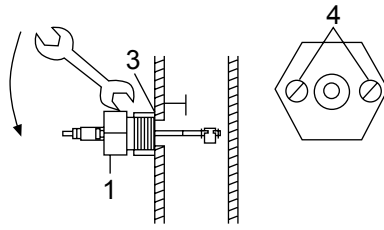

## Install the control housing

1. Loosen the screws that secure the cover (5) to the control housing about 1-1/2 turns. Remove cover.

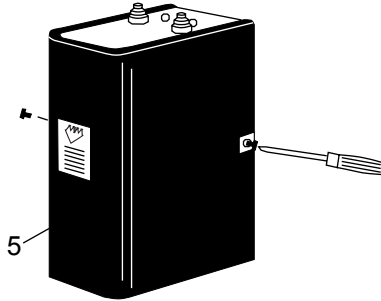

2. Loosen the probe mounting screws (4) 1-1/2 turns or 1/8" (3 mm).
3. Slip the control housing (6) over the two screws at a 20° angle.
4. Rotate the control housing (6) 20° counter-clockwise so that the slots in the control base are under the screws heads.
5. Tighten the mounting screws to approximately 2 ft·lbs. (2.6 N·M)

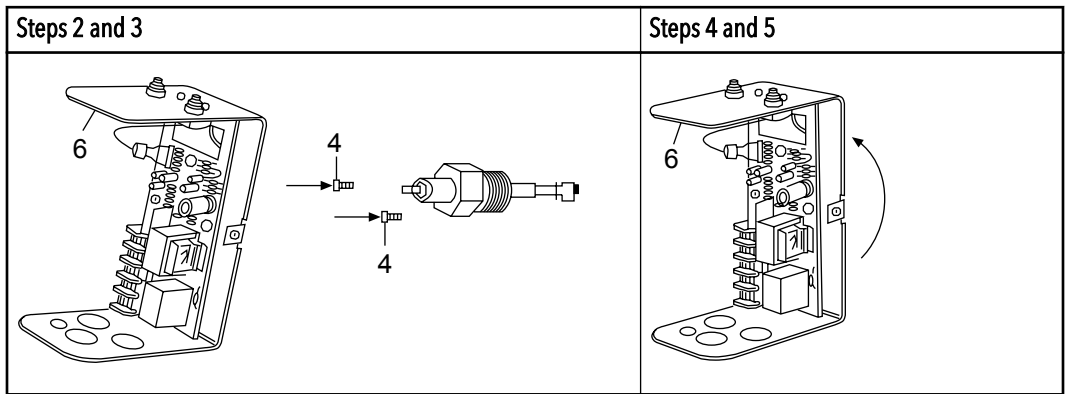

## Wire the probe to the control housing

1. Slip the ring terminal (7) followed by the lock washer (8) over the threaded end of the probe (1).
2. Tighten the wingnut (9) onto the probe to 1/2 ft·lb (.65 N·m).

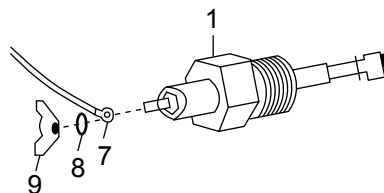

3. Connect the probe (1) to the wiring circuit by sliding the female quick-connect terminal of the probe wire (10) onto the male spade terminal (11). The male spade terminal is marked J3.

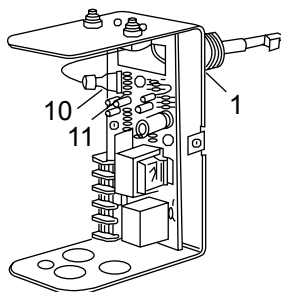

## Control to boiler wiring



### Warning:

- Fire hazard. Electrical wiring must have a rating of 167°F (75°C) if the liquid exceeds 180°F (82°C).
- When installing jumper wire make sure you are not introducing a second voltage source into the burner circuit and thereby bypassing other safety, limit, and operating controls.

Select a wiring method after reviewing the wiring diagrams and notes.

- Voltage of new manual reset LWCO must be the same as the existing automatic reset LWCO.
- Make sure the Factory jumper bar is installed on the existing auto reset probe type LWCO connecting terminals H and C. If there is no jumper bar connecting Terminals H and C, then consult the factory to discuss wiring options.
- For Option B, the power to the automatic reset LWCO turns off when the new manual reset LWCO detects a low water condition. The water feeder does not operate until the new manual reset LWCO detects water on the probe.
- For options A and C, the power to the new manual reset LWCO turns off when the existing auto reset LWCO detects a low water condition, reducing the chance of nuisance lockouts. The water feeder continues to operate because there is still power to the existing auto reset LWCO. Power to the new manual reset LWCO is restored when the auto reset LWCO detects water on the probe.

## Electrical conduit connections

- Connect electric conduit using knockouts provided.
- Follow accepted electrical practices for installation of fittings and connections.
- Refer to and follow local codes and standards when selecting the types of electrical fittings and conduit.

## Wire connections to the terminal block

Use the following instructions for all wire connections to the terminal block.

1. Strip about 1/3" (8.5 mm) of insulation from the wire.
2. Loosen the terminal screw (2) but do not remove it.
3. Move the wire clamping plate (3) back until the plate touches the back side of the screw head.
4. Insert the stripped end of the wire between the terminal block (1) and the wire clamping plate (3).
5. Tighten the terminal screw (2).

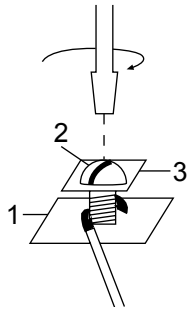

## Option A wiring

Voltage of the new manual reset LWCO is the same as the existing auto reset LWCO

1. Remove existing wire from terminal B of existing Auto Reset LWCO and connect to terminal B of new Manual Reset LWCO.
2. Connect new wire from terminal B of existing Auto Reset LWCO to terminal H of new Manual Reset LWCO.
3. Connect new wire from terminal N of existing Auto Reset LWCO to terminal N of new Manual Reset LWCO.

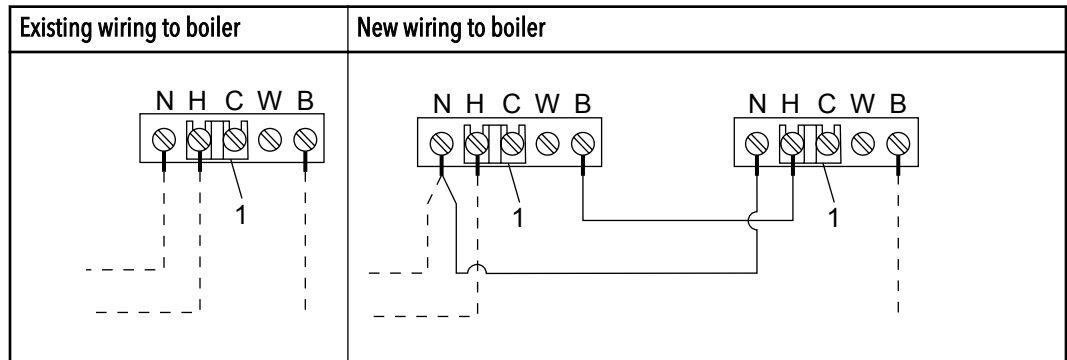

1. Factory jumper bar

----- Dashed lines indicate existing wires.

\_\_\_\_\_ Solid lines indicate new wires.

Water feeder should be wired to existing Auto Reset LWCO. Wiring diagrams for the water feeder can be found in the water feeder installation instruction manual.

## Option B wiring

Wiring a new 120 V manual reset LWCO to a boiler. Burner circuit voltage could be 24 V or 120 V. Existing LWCO could be either probe or float type.

1. Remove the existing hot "H" wire from the service switch and the L1 connection on the boiler.
2. Connect a new hot "H" wire from the service switch to terminal H on the LWCO.
3. Connect a new hot "H" wire from terminal "B" on the LWCO to the L1 connection on the boiler.
4. Connect a new wire to terminal "N" of the LWCO and splice it to the existing neutral "N" wire.

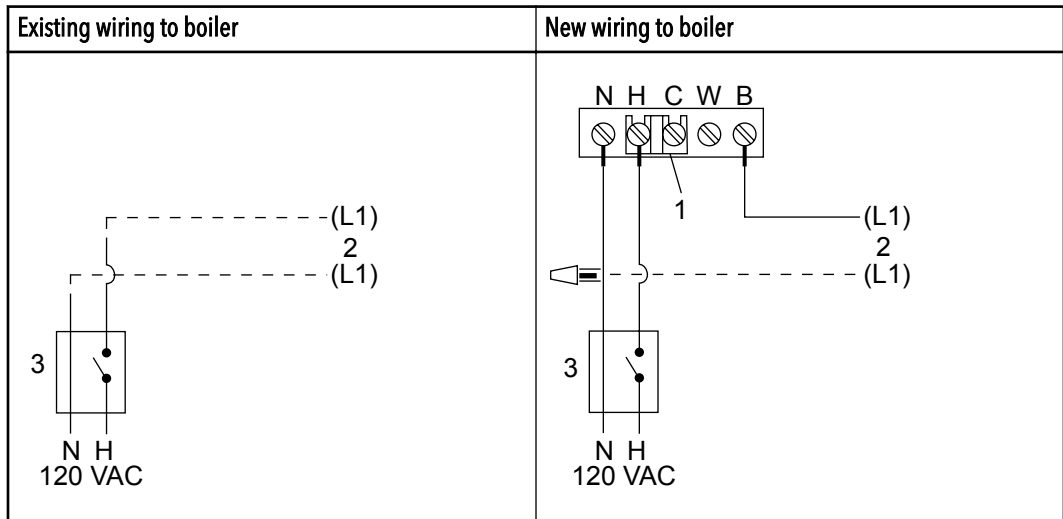

1. Factory jumper bar
2. Boiler connections
3. Service switch

----- Dashed lines indicate existing wires.

\_\_\_\_\_ Solid lines indicate new wires.

## Option C wiring

Wiring a new manual reset LWCO to a boiler with a Model 67 LWCO. Voltage of the new manual reset LWCO must be the same voltage as the burner circuit.

1. Remove existing wire from terminal 1 of the Model 67 LWCO and connect it to Terminal B of the new manual reset LWCO.
2. Connect a new wire from terminal 1 of Model 67 LWCO to terminal H of the new manual reset LWCO.
3. Connect a new wire to terminal N of new manual reset LWCO and splice it to the existing neutral wire.

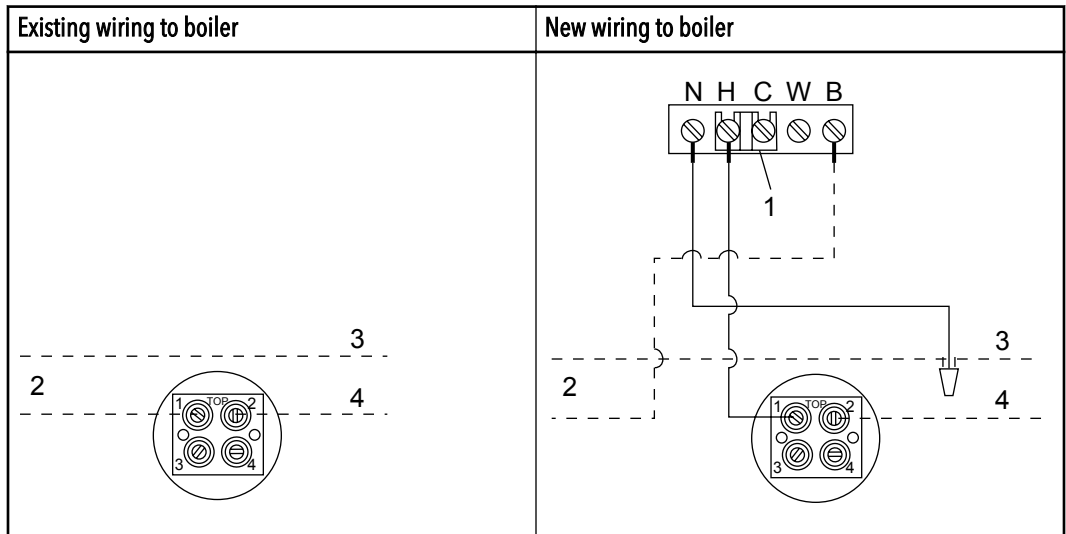

1. Factory jumper bar
  2. To burner
  3. Neutral
  4. Hot
- Dashed lines indicate existing wires.  
 \_\_\_\_\_ Solid lines indicate new wires.

---

# Commissioning, Startup, Operation, and Shutdown

## Start up the boiler

1. Before filling the system, turn on the electric power to the boiler.
  - a) Upon initial power up, the green and red lights will flash simultaneously four times.
  - b) The green light will turn on and the red light will begin to flash.
  - c) After 60 seconds, the red light will stop flashing and will remain on.
  - d) The burner will never turn on as long as there is no water on the probe.
2. Fill the boiler with water.
  - a) When water touches the probe, the green and red lights will remain on.
  - b) After depressing manual reset button, the green and red lights will flash four times simultaneously.
  - c) The green light will then turn on and the red light will turn off.
  - d) The burner will turn on as long as there is water on the probe.

## Test the probe

Drain water from the boiler.

- a) The burner turns off and the Red light begins to flash when there is no water on the probe.
- b) After 60 seconds, the red light will stop flashing and will remain on.  
**IMPORTANT:** If water returns to the level of the probe at any time while the red light flashes, then the control automatically resets.
- c) The control is now locked out. The manual reset button has to be depressed when water touches the probe.

## Test the manual reset button

1. Test the cycle by depressing and holding the test button. The burner turns off and the red light begins to flash.
2. Red light stops flashing and remains on after 60 seconds.
3. Control is now locked out and burner remains off when test button is released.
4. Depress manual reset button. Green and red lights flash simultaneously four times.
5. Green light turns on and red light turns off.
6. Burner turns on as long as there is water on the probe.

# Maintenance

## Maintenance schedule

---



**Warning:**

- Maintenance and service must be performed by skilled and qualified personnel only.
  - Replace probe when PFA insulator is cracked or worn or probe is loose.
- 

- Test the low water cut-off annually.
- Remove and inspect the self-cleaning probe every five years.
  - Use a non-abrasive cloth and rinse with clean water when the probe requires cleaning. Do not use sharp instruments to remove accumulations of rust or scale.
- Replace probe every ten years.
- Replace the low water cut-off control box every 15 years.



---

# Troubleshooting

## Probe fails to operate

Perform the following diagnostic checks if the probe fails to operate as required:

1. Check that the water level in the boiler is at or above the level of the probe.
2. Recheck all wiring to ensure proper connections as specified in the wiring diagrams of the boiler manufacturer or in this instruction manual.
3. Check to ensure that PTFE tape has not been used on the threaded connection of the electrode to the boiler.
4. Some foaming is common in certain boilers. Refer to recommendations from the boiler manufacturer for cleaning the boiler and piping when excessive foaming occurs.





# Xylem |'zīləm|

- 1) The tissue in plants that brings water upward from the roots
- 2) A leading global water technology company

We're 12,500 people unified in a common purpose: creating innovative solutions to meet our world's water needs. Developing new technologies that will improve the way water is used, conserved, and re-used in the future is central to our work. We move, treat, analyze, and return water to the environment, and we help people use water efficiently, in their homes, buildings, factories and farms. In more than 150 countries, we have strong, long-standing relationships with customers who know us for our powerful combination of leading product brands and applications expertise, backed by a legacy of innovation.

For more information on how Xylem can help you, go to [xylem.com](http://xylem.com)



Xylem Inc.  
8200 N. Austin Avenue  
Morton Grove, IL 60053  
Tel. 1-847-966-3700  
Fax 1-847-965-8379  
[www.xylem.com/brands/mcdonnellmiller](http://www.xylem.com/brands/mcdonnellmiller)

Visit our Web site for the latest version of this document and more information

The original instruction is in English. All non-English instructions are translations of the original instruction.

© 2012 Xylem Inc.

McDonnell & Miller is a trademark of Xylem Inc or one of its subsidiaries.