

**For Residential and Commercial Applications**

Job Name \_\_\_\_\_

Contractor \_\_\_\_\_

Job Location \_\_\_\_\_

Approval \_\_\_\_\_

Engineer \_\_\_\_\_

Contractor's P.O. No. \_\_\_\_\_

Approval \_\_\_\_\_

Representative \_\_\_\_\_

**LEAD FREE\***

**Series LF26A, LF263A**  
**Small Pressure Regulators**

Sizes: **LF26A:** 1/8" – 1/2"  
**LF263A:** 1/4" – 1/2"

Series LF26A, LF263A Small Pressure Regulators are general purpose pressure regulators for water service. The LF26A, LF263A features Lead Free\* construction to comply with Lead Free\* installation requirements. These regulators are ideal for use in beverage dispensers, ice cube machines and other similar applications. Lead Free\* small pressure regulators shall comply with state codes and standards, where applicable, requiring reduced lead content.

**Features**

- Rugged forged Lead Free\* Brass body
- Tee handle adjustment
- Oversized orifice

**Models**

- LF26A** 2-way regulator
- LF263A** 3-way regulator

**Materials**

- Body: Lead Free\* Brass
- Spring Cage: Aluminum
- Disc: Buna-N stainless steel
- Diaphragm: Reinforced Buna-N

**Pressure – Temperature**

Temperature Range: 0°F – 140°F (-18°C – 60°C)  
 Maximum Working Pressure: 300psi (21 bar)  
 Reduced Pressure Range:

SUFFIX	RANGE		STD. SET AT	
	psi	bar	psi	bar
A	1 – 25	0.1 – 1.7	10	0.7
B	3 – 50	0.2 – 3.4	15	1.0
C	10 – 125	0.7 – 8.6	25	1.7
D	50 – 175	3.4 – 12.1	50	3.4

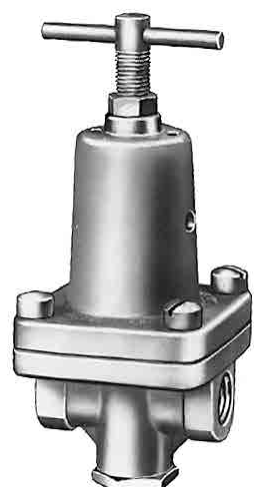

LF26A  
2-Way



LF263A  
3-Way

**Options**

- G Pressure gauge
- SS All stainless steel construction
- X Slotted adjusting screw

**NOTICE**

The information contained herein is not intended to replace the full product installation and safety information available or the experience of a trained product installer. You are required to thoroughly read all installation instructions and product safety information before beginning the installation of this product.

**NOTICE**

Inquire with governing authorities for local installation requirements

\*The wetted surface of this product contacted by consumable water contains less than 0.25% of lead by weight.

Watts product specifications in U.S. customary units and metric are approximate and are provided for reference only. For precise measurements, please contact Watts Technical Service. Watts reserves the right to change or modify product design, construction, specifications, or materials without prior notice and without incurring any obligation to make such changes and modifications on Watts products previously or subsequently sold.



# Capacity

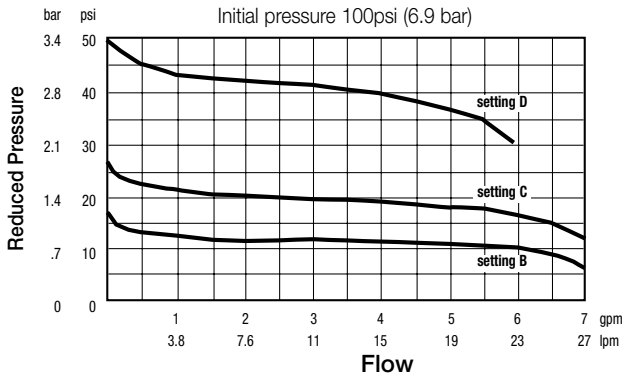

# Approvals



Certified to NSF/ANSI 61-G

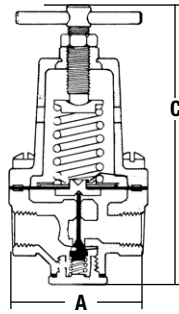

# Dimensions – Weights

MODEL	SIZE	DIMENSIONS				WEIGHT	
		A		C		lbs.	kgs
	in.	in.	mm	in.	mm		
LF26A	1/8	2 1/8	54	4 3/8	111	1	.45
LF26A/LF263A	1/4	2 1/8	54	4 3/8	111	1	.45
LF26A/LF263A	3/8	2 1/8	54	4 3/8	111	1	.45
LF26A/LF263A	1/2	2 1/8	54	4 3/8	111	1	.45



USA: T: (978) 689-6066 • F: (978) 975-8350 • Watts.com  
 Canada: T: (905) 332-4090 • F: (905) 332-7068 • Watts.ca  
 Latin America: T: (62) 81-1001-8600 • Watts.com