

RESCUE® Motors Permanent Split Capacitor Condenser Fan 5.6" Diameter, Totally Enclosed Air Over (TEAO)



APPLICATIONS:

Commercial and Residential Condensing Units. Can replace a range of horsepower application and a variety of mounting styles.

FEATURES:

- High 158°F (70°C) Or 140°F (60°C) Ambient Designs
- Automatic Reset Thermal Overload Protector
- Designed For Use With 370V Capacitors
- Special Treated Rotor For Corrosion Protection
- Includes Lead End Mounting Holes For RHEEM® or TRANE® Units
- 48" Leads
- Extended Mounting Studs
- Ball Bearings
- Reversible Rotation
- High Efficiency Design
- Continuous Duty, Air Over
- Reversible Rotation
- 208v will not be marked on DOE regulated spread-voltage motors. Refer to online data

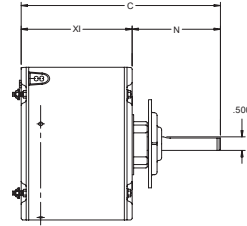

RESCUE® Condenser Motors available in
158°F (70°C) ambient ratings! See below

HP	RPM	Voltage	Catalog Number	List	Max. Ambient	Speed Tap	Cap. MFD	Amps	Shaft N	Shell XI	Total C	Ship Wt.	Notes
1/3 1/4 1/5 1/6	825	208-230	5464	◆	140°F(60°C)	High High Low Low	7.5 7.5 7.5 7.5	1.9 1.5 1.2 1.0	5	5.3	10.3	18	H43
1/3 1/4 1/5 1/6	825	208-230	5464H	◆	158°F(70°C)	High High Low Low	7.5 7.5 7.5 7.5	1.9 1.5 1.2 1.0	5	5.3	10.3	18	H43
1/3 1/4 1/5 1/6	1075	208-230	5472	◆	140°F(60°C)	High High High High	7.5 7.5 7.5 7.5	2.4 2.4 2.4 2.4	5	3.8	8.8	11	H43
1/3 1/4 1/5 1/6	1075	208-230	5462	◆	140°F(60°C)	High High Low Low	5 5 5 5	2.6 2.5 2.0 1.8	5	4.6	9.6	14	H43
1/3 1/4 1/5 1/6	1075	208-230	5462H	◆	158°F(70°C)	High High Low Low	5 5 5 5	2.6 2.5 2.0 1.8	5	4.6	9.6	14	H43
1/2 1/3 1/4 1/5	1075	208-230	5465	◆	140°F(60°C)	High High Low Low	10 10 10 10	3.0 2.2 1.6 1.3	5	5.3	10.3	15	H43
1/2 1/3 1/4 1/5	1075	208-230	5465H	◆	158°F(70°C)	High High Low Low	10 10 10 10	3 2.2 1.6 1.3	5	5.3	10.3	19	H43
3/4 1/2 1/3 1/4	1075	208-230	5482H	◆	158°F(70°C)	High High Low Low	15 15 15 15	4 2.8 1.9 1.4	5.5	6.3	11.8	21	H43

460 Volt RESCUE® Condenser Fan Motors

HP	RPM	Voltage	Catalog Number	List	Max. Ambient	Speed Tap	Cap. MFD	Amps	Shaft N	Shell XI	Total C	Ship Wt.	Notes
1/2 1/3 1/4 1/5 1/6	1075	460	5480H	◆	158°F(70°C)	High High Low Low Low	10 10 10 10 10	1.3 0.9 0.7 0.5 0.5	5.5	5.6	11.1	20	H43
3/4 1/2 1/3 1/4	1075	460	5481H	◆	158°F(70°C)	High High Low Low	15 15 15 15	2.2 1.3 1.1 0.7	5.5	6.3	11.8	25	H43

◆ Refer to Motorboss for Pricing

Note H43: Side Shell & Lead End Mounting Screws Included In Carton

