



Perfect Circles

EVERY TIME!

Lightweight aluminum frames make Malco hole cutters extremely portable for a variety of holes in sheet metal including 20-gauge (1.02 mm) galvanized steel.

For Reference

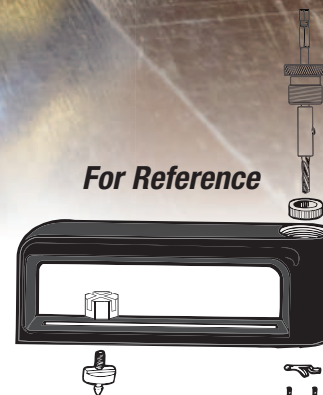

Replacement Parts

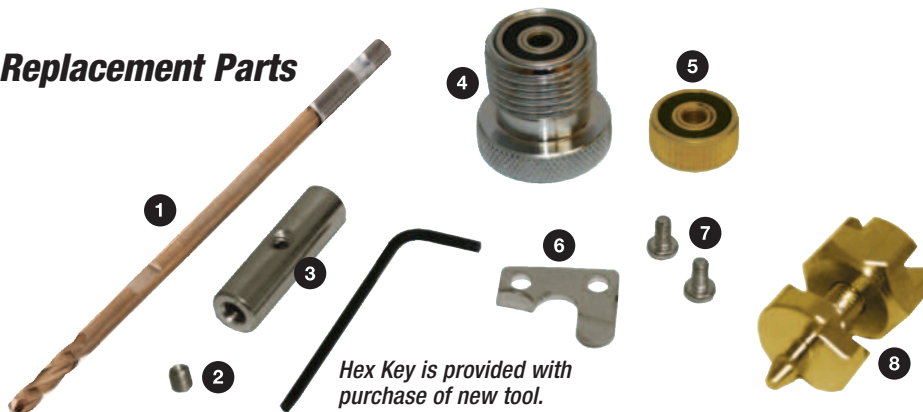

Hex Key is provided with purchase of new tool.

Replacement Parts

- | | |
|----|--|
| 1. | CB - Cutter Bit |
| 2. | HC1H - Screw Only |
| 3. | HC1E - Adjustment Sleeve (with screw included) |
| 4. | HC1D - Thrust Bearing |
| 5. | HC1K - Bearing |
| 6. | HC1G - Shoe |
| 7. | HC1I - Shoe Screws |
| 8. | HC1B - Pivot Pin Set |